



Hilton
North Raleigh

Travel should take you places®

Hilton North Raleigh

3415 Wake Forest Road, Raleigh, North Carolina 27609

Tel: 919-872-2323 Fax: 919-876-0890

www.northraleigh.hilton.com

Location

Just 3.5 miles from the State Capital of North Carolina and great shopping, upscale restaurants, Raleigh attractions and award-winning Universities. Two blocks north of the I-440 beltline which offers easy access to I-40, I-85 and I-95. 15 miles from Raleigh-Durham International Airport, 20 miles from Research Triangle Park and 4 miles from North Carolina State University.

For your next meeting or special event, call the Hilton North Raleigh at 919-872-2323 or Hilton Direct® at 1-800-321-3232, or visit www.hilton.com.

Meeting Facilities

- 30,300 sq. ft. of first floor flexible function space in 19 rooms; set theater style, the Grand Ballroom can accommodate 1,500 guests and the Capital Ballroom can accommodate 1,000 guests
- Hilton Boardroom featuring granite top Conference table with ergonomic highback leather seating for 14, conversation area, in-room safe and refrigerator, built in audio visual services including a 52" LCD high-definition television
- Hilton Multi-Purpose Room
- High-speed wired Internet access in all meeting rooms
- Complete conference services staff and on-site audio/visual sales and support team
- With E-events, guest rooms and meeting space can be checked 24/7 through our website www.northraleigh.hilton.com

Guestrooms and Suites Feature

- 338 guestrooms (including 7 suites)
- Club Level key access floor with 59 executive rooms and featuring private lounge amenities accessible 24 hours with complimentary breakfast and evening hors d'oeuvres
- The Hilton Serenity Bed, featuring the Serta Perfect Sleeper Suite Dreams mattress, down comforter & pillows with 250 thread count linens
- High-speed wireless Internet access in all guest rooms
- Non-smoking & accessible rooms
- Four rooms with roll-in capable showers
- Two dual-line speakerphones with programmable voicemail and data ports
- Large work desk with convenient desk-level outlets and ergonomic chair
- Cuisinart coffeemaker
- 37" flat panel cable high-definition TV with pay-per-view movies
- Crabtree & Evelyn® bath amenities
- Complimentary USA Today® delivered each weekday morning
- Iron and ironing board; hair dryer
- Individual guest controlled heating and cooling
- Innovative Hilton clock with easy-to-set alarm and adaptor for portable MP3
- Electronic key access door locks

Hotel Services and Amenities

- 24-hour business center with computers, fax, photocopy and laptop connection capabilities
- Skybox Grill and Bar featuring 45 flat screen TV's and Interactive Gaming
- Lofton's Corner featuring the Hilton Breakfast and proudly serving Starbucks® coffee
- Room service
- Heated indoor swimming pool and whirlpool spa
- Precor® Fitness Center by Hilton - Open 24 hours
- 24-hour gift shop
- ATM machine located in the lobby
- Safety deposit boxes
- Multi-lingual staff
- Same-day valet laundry services (M-F)

Hilton HHonors®

- Hilton HHonors is the only guest reward program that lets you earn both hotel points and airline miles for the same stay at more than 2,900 hotels worldwide.
- With the Hilton HHonors Event Planner program, Event Planners can earn Points & Miles® for qualifying events. Ask your sales professional for details.

Hilton HHonors

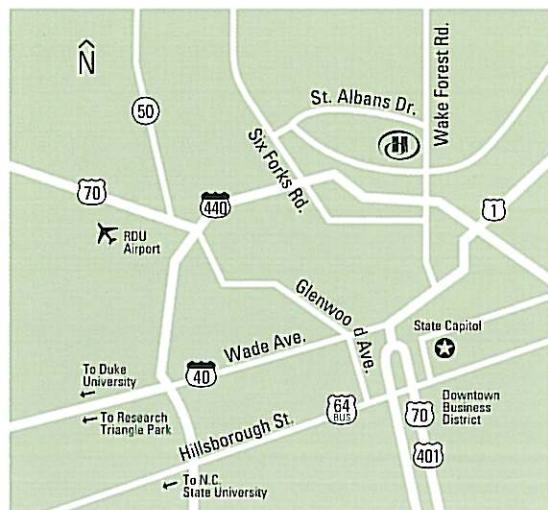



	LxWxH	Square Feet	Classroom	Theatre	Rounds	Reception	Conference	U-Shape
Grand Ballroom	128.5 x 77 x 16'	10,060	625	1,500	840	1,400	—	—
Ballroom 1	38.5 x 31.58 x 16'	1,250	60	150	70	175	28	30
Ballroom 2	38.5 x 29 x 16'	1,130	60	150	80	150	28	30
Ballroom 3	78 x 32 x 16'	2,500	156	325	180	300	70	70
Ballroom 4	78 x 32 x 16'	2,500	156	325	180	300	70	70
Ballroom 5	78 x 32 x 16'	2,500	156	325	180	300	70	70
Capital Ballroom	152 x 50 x 12'	8,380	500	1,000	640	1,200	—	—
Salon A	25' x 25'	625	30	50	40	50	20	18
Salon B	25' x 25'	625	30	50	40	50	20	18
Salon C	39.07' x 32'	1,250	60	150	80	150	40	40
Salon D	39.07' x 32'	1,250	60	150	80	150	40	40
Salon E	39.07' x 32'	1,250	60	150	80	150	40	40
Salon F	35.42' x 30.49'	1,690	80	200	100	250	50	50
Salon G	35.42' x 30.49'	1,690	80	200	100	250	50	50
1-Dogwood	35' x 25'	875	40	80	50	60	26	24
2-Boxwood	36.75' x 34.28'	1,260	60	130	70	120	32	30
3-Congressional	26.5' x 12.83' x 8'	340	12	25	20	20	16	—
4-Judicial	26.5' x 25.47'	675	30	60	40	50	22	18
5-Boardroom	26.5' x 25.47'	675	—	—	—	—	14	—
6-Sandalwood	26.5' x 25.47'	675	30	60	40	50	22	18
7-Oakwood	26.17' x 19.87'	520	25	25	30	30	18	15

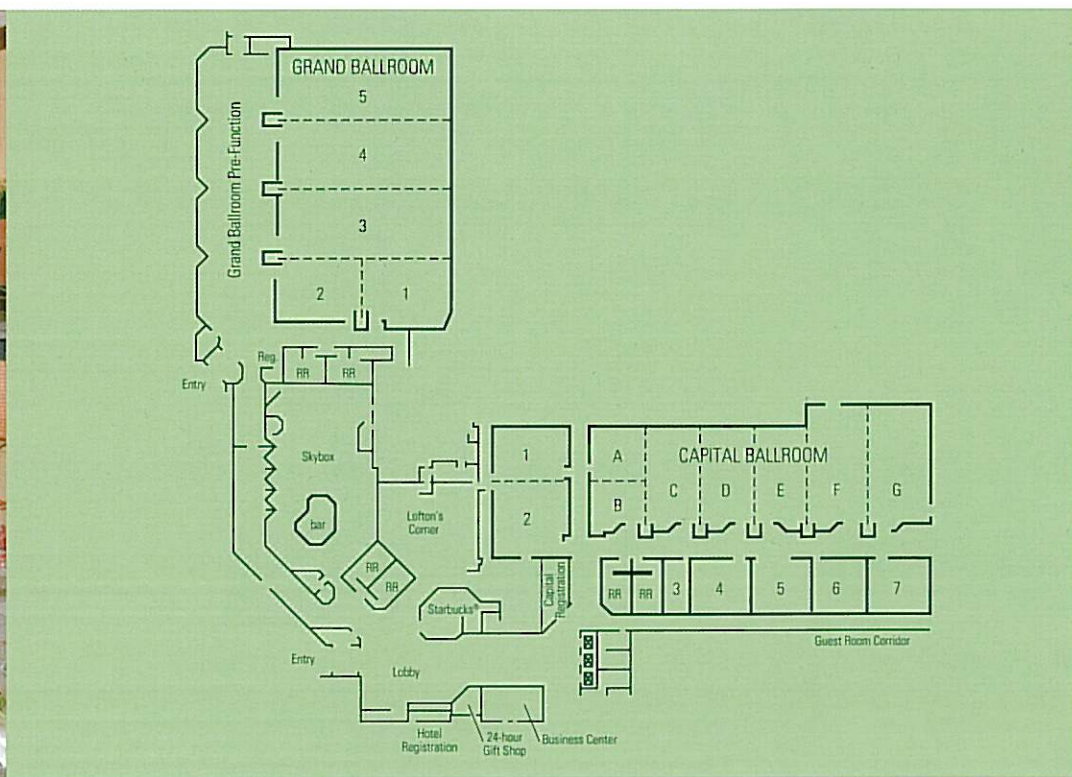

Call our dedicated Conference Professionals at 919-872-2323 or Hilton Direct® at 1-800-321-3232, or visit www.hilton.com.